

Model	Item #	Torque Ranges		Graduation		Square Drive
		American	S.I.	American	S.I.	
EPT250i-D	280033	50 - 250 lbf.in	6.2 - 28.8 N.m	1 lbf.in	0.1 N.m	1/4"
EPT250i-A	280034	50 - 250 lbf.in	6.2 - 28.8 N.m	1 lbf.in	0.1 N.m	3/8"
EPT75F	280035	15 - 75 lbf.ft	23.7 - 105.1 N.m	0.5 lbf.ft	0.5 N.m	3/8"
EPT150F	280036	10 - 150 lbf.ft	20.3 - 210.1 N.m	1 lbf.in	1 N.m	1/2"
EPT250F	280037	30 - 250 lbf.ft	47.4 - 345.7 N.m	2 lbf.ft	2 N.m	1/2"
EPT400F	280038	80 - 400 lbf.ft	142.3 - 559.2 N.m	2.5 lbf.ft	2.5 N.m	3/4"
EPT550F	280039	110 - 550 lbf.ft	183 - 779.5 N.m	2.5 lbf.ft	5 N.m	3/4"
EPT750F	280040	150 - 750 lbf.ft	237.2 - 1050.6 N.m	5 lbf.ft	5 N.m	1"

Model	Item #	Graduation	Length (mm)	Width (mm)	Lf (mm)
EPT250i-D	280033	1 lbf.in	245	27.3	195.2
EPT250i-A	280034	1 lbf.in	245	27.3	195.2
EPT75F	280035	0.5 lbf.ft	410	36.4	329.5
EPT150F	280036	1 lbf.ft	520	41	435
EPT250F	280037	2 lbf.ft	610	41	525
EPT400F	280038	2.5 lbf.ft	1012	58	918.8
EPT550F	280039	2.5 lbf.ft	1125	58	1031.8
EPT750F	280040	5 lbf.ft	1225	67	1127.6

Calibration & Maintenance

Torque wrenches go out of calibration with use. A wrench must be properly calibrated and maintained on a preventative maintenance and calibration schedule. In order to maintain accuracy, it is crucial that a wrench be calibrated regularly using a torque tester.

Calculations For Torque Wrench Extensions

When using extensions, the torque applied to the nut is greater than the setting. To ensure that the correct torque is applied when using extensions, keep the extension "in-line" with the axis of the wrench (as shown in diagram). To calculate the increase, use the formula below:

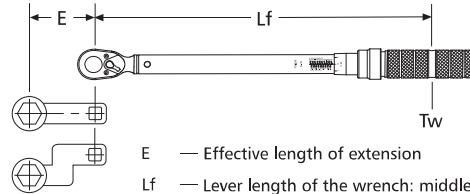

- E — Effective length of extension
 - Lf — Lever length of the wrench: middle of handle to center of square drive
 - Tw — Torque setting on the wrench
 - Ta — Torque applied by the extension to the fastener
- $$Tw \text{ (Torque Setting)} = Ta \times \frac{Lf}{Lf+E}$$

111 mountz[®]

FOR INDUSTRIAL ASSEMBLY

EPT TORQUE WRENCH

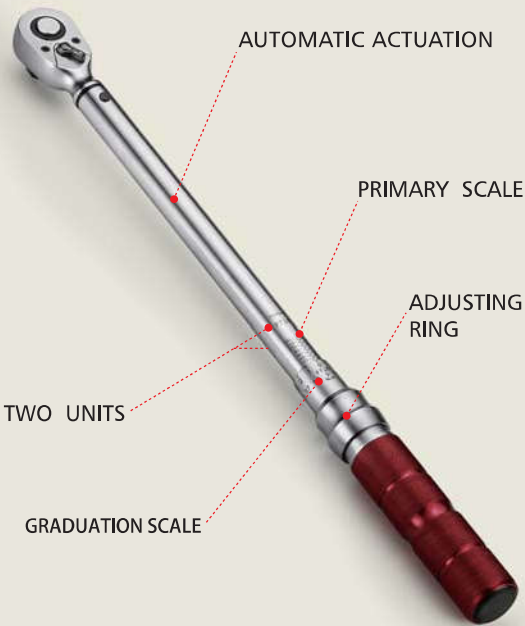

OPERATION MANUAL

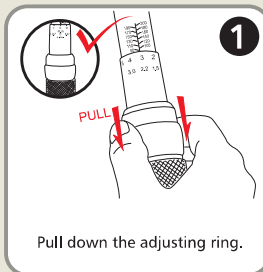

Pull down the adjusting ring.

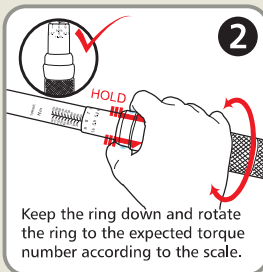

Keep the ring down and rotate the ring to the expected torque number according to the scale.



Make sure the ring table indicates the expected torque number, release the adjusting ring.

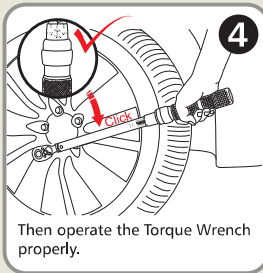

Then operate the Torque Wrench properly.

TIPS FOR EPT TORQUE WRENCH

FEATURES

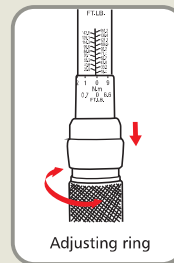

Adjusting ring

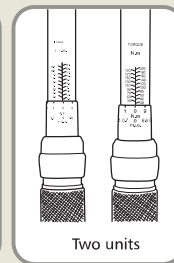

Two units

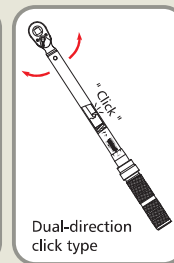

Dual-direction click type

NOTE

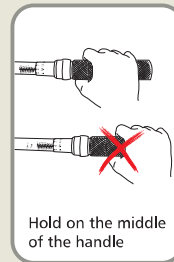

Hold on the middle of the handle

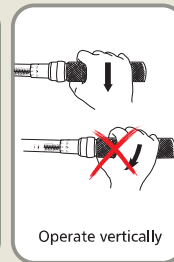

Operate vertically

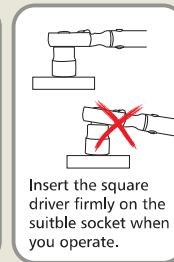

Insert the square driver firmly on the suitable socket when you operate.